

| | | | | | | |
|--|----------------------------|---|----------------------------------|---------------------------------|---------------------------|------------------|
| | S E L E C T | A | ←→ Min=1.715mm Max=3.430mm | ↕ Min=1.000mm Max=2.500mm | Min. Thickness: 3mm | Max. 1.000kg |
| | | B | ←→ Min=3.430mm Max=5.145mm | ↕ Min=1.000mm Max=2.500mm | | Max. 1.666 kg |
| | | C | ←→ Min=5.145mm Max=6.860mm | ↕ Min=1.000mm Max=2.500mm | | Max. 2.333 kg |
| | | D | ←→ Min=6.860mm Max=9.000mm | ↕ Min=1.000mm Max=2.500mm | | Max. 3.000 kg |

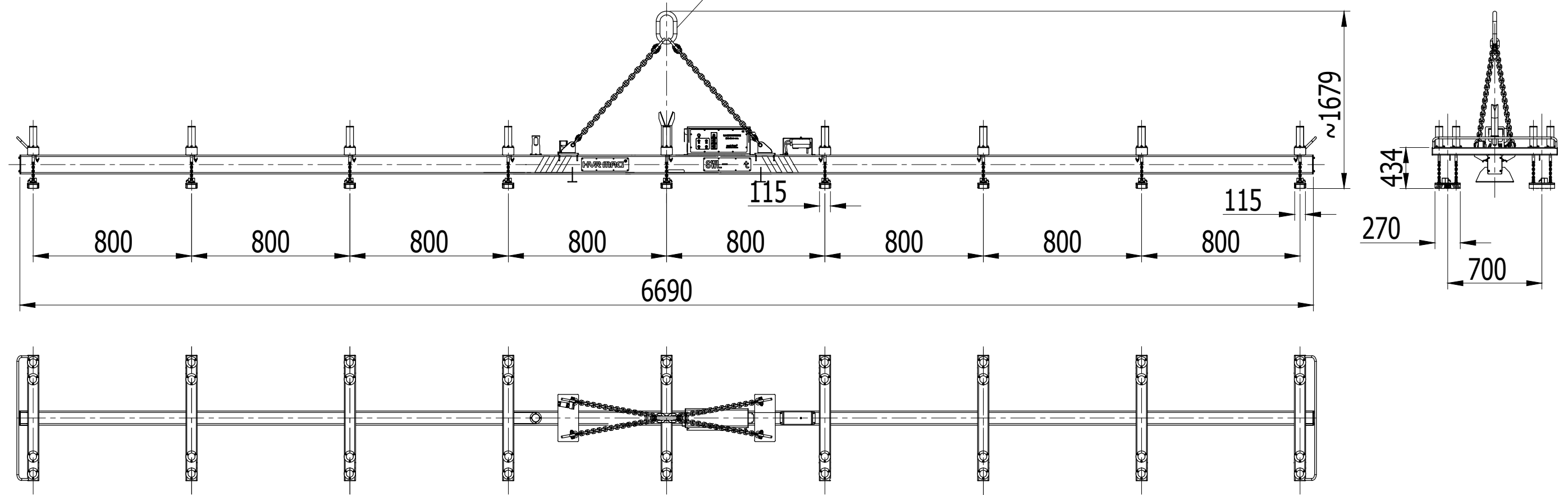
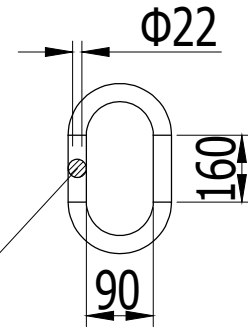

Indicative Weight: 1.000 kg

Indicative drawing. We reserve the right to modify the design at any time

| Index | Date | Modification | Name |
|---|------|--------------|------------------|
| | | | |
| | | | HVR MAG® |
| HM3-09-030 EPM beam for lifting of steel plate | | | Date: 30/06/2020 |
| | | | Scale: 1:65 |
| HFA20143.00 Indicative drawing | | | Checked: BIN |
| | | | Unit:mm |